

2025 Spring Specials

Quarterly Special valid from April 1st – June 30th, 2025

Revenue Grade Meter EEM-MA370-MC-REV

NEW

Phoenix Contact introduces its first Revenue Grade Meter. The EEM-MA370-MC-REV power meter is perfectly designed for billing applications within the commercial, residential and industrial space.

The Measurement Canada certification ensures protection against unauthorized tampering while supporting its Modbus TCP/IP protocol and Ethernet connection enabling seamless integration and visualization of energy data through a web interface or compatible control system.



[Learn more online...](#)

Contact info:
Divesh Boodhna, C.E.T., CPM®
Product Manager,
Switching, Conditioning & Measurement
647-220-3205
dboodhna@phoenixcontact.ca

Service Configurations	Voltage (V)	Current (A) CT Secondary	Frequency	Temp.	Approved Energy
1 element 2 wire	120	0.01 – 1.00 0.05 – 5.00	60 Hz	-25°C to 53°C	Delivered Energy (kWh)
3 element 4 wire Y	120, 240, 277, 347, 480, 600				
3 element 4 wire Δ	120, 240, 480, 600				

All orders must reference promo code *****SPRING2025*****. Quarterly Special valid from April 1st – June 30th, 2025. All prices are customer net each.

*Please note that ALL pricing is in CAD and this special is only available in Canada

PLCnext Technology Starterkit

Ecosystem for limitless automation

PLCnext Technology Starterkit is the perfect jumping off point for learning about edge and IoT. The PLCnext features an open ecosystem and free programming software. It can be used as a traditional controller, an edge device, or both at the same time! The platform is also very secure boasting IEC 62443-4-2 certification.

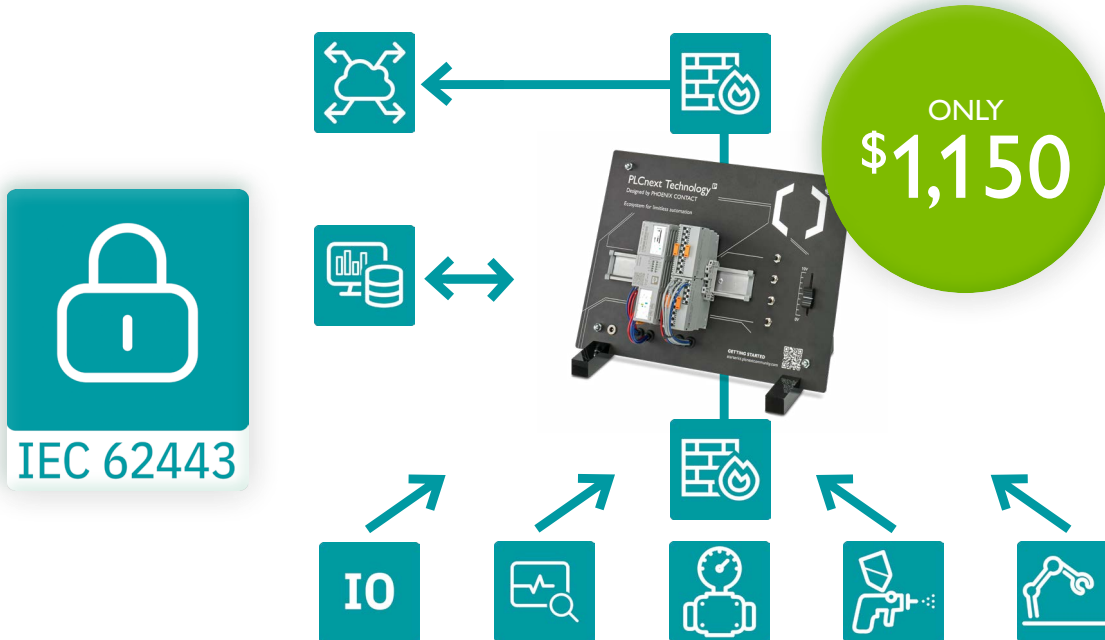

Panel Feed Through Solutions

Our Panel Feed Through facilitates seamless signal transfer between control cabinets and outside world. Available in multiple configurations, including different ports, sizes, connector types, and mounting styles, to suit diverse power, data and signal requirements.



Features and Benefits

- ✓ **Secure Connectivity:** Ensures reliable and uninterrupted data flow
- ✓ **Versatile Compatibility:** Supports a wide range of data and signal types
- ✓ **Easy Installation:** Push-lock facilitates fast, flexible and color-coded installation

Order no.	Description	Details	Promo Price
1425186	SI-RND-R1A	RJ45/RJ45 feed through with cover	\$28.99
1414398	CUC-BH-M12D1PBK-S/R4BE	D-coded to RJ45 socket feed through	\$49.99
1414396	CUC-BH-M12A1PBK-S/R4BE	A-coded to RJ45 socket feed through	\$49.99
1404549	VS-BH-M12FSX-10G-RJ45/180	X-coded to RJ45 socket feed through	\$54.99
1424326	SACC-4P-DSI-M12FSD/FSD-M16	D-coded to D-coded M12 feed through	\$59.99
1139804	SACC-E-M12MS-5PL-M20	M12 male 5-position Push-lock feed-through	\$19.99
1139805	SACC-E-M12FS-5PL-M20	M12 female 5-position Push-lock feed-through	\$19.99

Panel Mount Power Supply

TRIO 24VDC 2500W output

TRIO-PM is the perfect power supply for DC loads like fan cooling or liquid cooling in BESS and data centre applications.



Your Advantages

- ✓ Small size, high efficiency & robust design
- ✓ High EMC performance
- ✓ Integrated ORING Diode for parallel connection
- ✓ Communication for smart monitoring and maintenance

Order no.	Description	Input Voltage	Output Voltage	Output Power	Promo Price
1635194	TRIO-PM/1AC/24DC/2500W	180-264VAC	24VDC	2500W	\$788.00
		90-180VAC	24VDC	1500W	

QUINT4 Industrial Inverter

120V/230VAC from 24VDC

The QUINT4 industrially hardened inverter provides 120V & 230V AC power from 24VDC grids. Choose between single or parallel operation to create a redundant or 3phase AC networks.

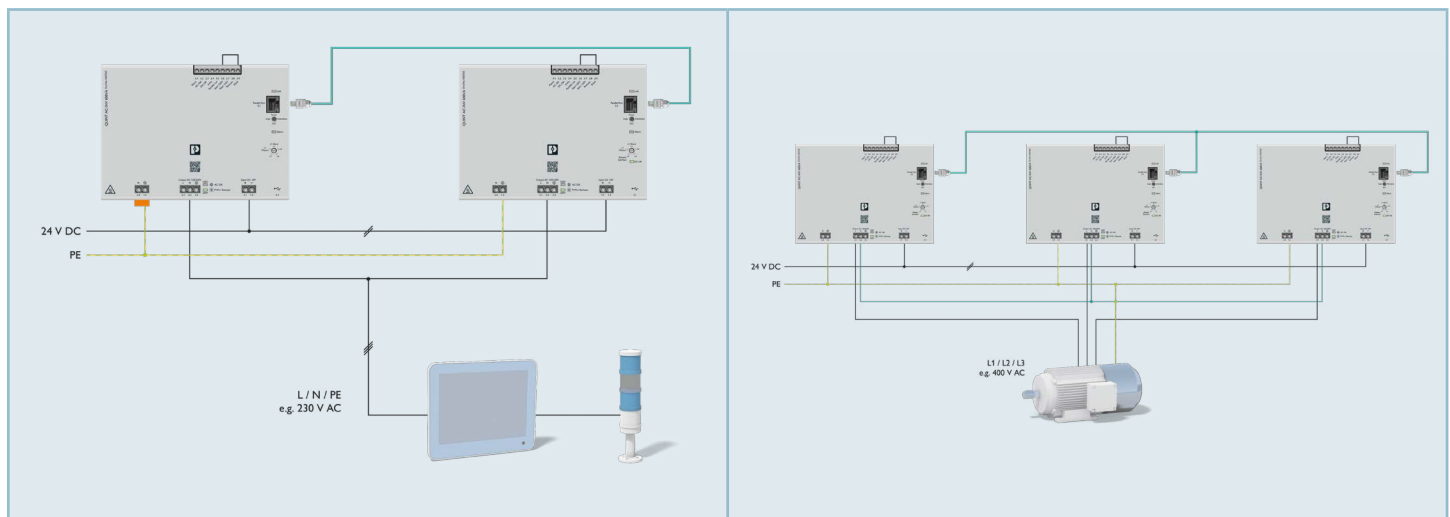

Order no.	Description	Voltage	Apparent Power	Promo Price
1067325	QUINT4-INV/24DC/1AC/600VA/USB	24VDC	600VA	\$1485.00





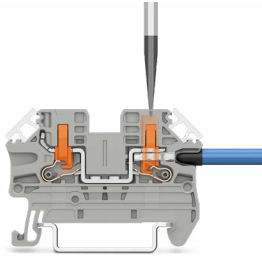

Push-in Technology — PTV

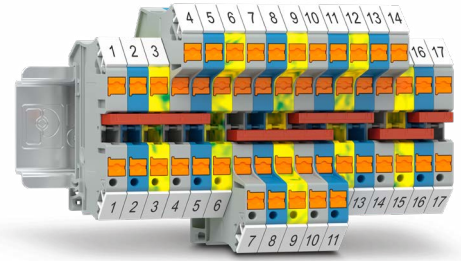
 [Learn more online...](#)



The PTV terminal block family combines the advantages of tool-free Push-in connection with the lateral conductor routing of a screw terminal block. The PTV terminal blocks thus offer direct, fast connection technology and clearly arranged wiring without bending radii in a single terminal block.



	<p>\$0.85</p> <p>PTV 2,5 1078960</p> <p>AWG 26 ... 12 — 600V / 20A</p> <p>Accessories</p> <table border="1"> <tr> <th>Marking</th> <th>End Cover</th> </tr> <tr> <td>0828734 UCT-TM 5</td> <td>1088746 D-PTV 2,5/4</td> </tr> <tr> <td>\$5.30 / Card</td> <td>\$0.75</td> </tr> </table>	Marking	End Cover	0828734 UCT-TM 5	1088746 D-PTV 2,5/4	\$5.30 / Card	\$0.75		<p>\$4.00</p> <p>PTV 2,5-PE 1078963</p> <p>Accessories</p> <table border="1"> <tr> <th>Marking</th> <th>End Cover</th> </tr> <tr> <td>0828734 UCT-TM 5</td> <td>1088746 D-PTV 2,5/4</td> </tr> <tr> <td>\$5.30 / Card</td> <td>\$0.75</td> </tr> </table>	Marking	End Cover	0828734 UCT-TM 5	1088746 D-PTV 2,5/4	\$5.30 / Card	\$0.75		<p>\$1.25</p> <p>PTV 2,5-QUATTRO 1078999</p> <p>AWG 26 ... 12 — 600V / 20A</p> <p>Accessories</p> <table border="1"> <tr> <th>Marking</th> <th>End Cover</th> </tr> <tr> <td>0828734 UCT-TM 5</td> <td>1088748 D-PTV 2,5/4-QUATTRO</td> </tr> <tr> <td>\$5.30 / Card</td> <td>\$0.80</td> </tr> </table>	Marking	End Cover	0828734 UCT-TM 5	1088748 D-PTV 2,5/4-QUATTRO	\$5.30 / Card	\$0.80
Marking	End Cover																						
0828734 UCT-TM 5	1088746 D-PTV 2,5/4																						
\$5.30 / Card	\$0.75																						
Marking	End Cover																						
0828734 UCT-TM 5	1088746 D-PTV 2,5/4																						
\$5.30 / Card	\$0.75																						
Marking	End Cover																						
0828734 UCT-TM 5	1088748 D-PTV 2,5/4-QUATTRO																						
\$5.30 / Card	\$0.80																						
	<p>\$1.00</p> <p>PTV 4 1088728</p> <p>AWG 24 ... 10 — 600V / 30A</p> <p>Accessories</p> <table border="1"> <tr> <th>Marking</th> <th>End Cover</th> </tr> <tr> <td>0828736 UCT-TM 6</td> <td>1088746 D-PTV 2,5/4</td> </tr> <tr> <td>\$5.30 / Card</td> <td>\$0.75</td> </tr> </table>	Marking	End Cover	0828736 UCT-TM 6	1088746 D-PTV 2,5/4	\$5.30 / Card	\$0.75		<p>\$4.50</p> <p>PTV 4-PE 1088730</p> <p>Accessories</p> <table border="1"> <tr> <th>Marking</th> <th>End Cover</th> </tr> <tr> <td>0828736 UCT-TM 6</td> <td>1088746 D-PTV 2,5/4</td> </tr> <tr> <td>\$5.30 / Card</td> <td>\$0.75</td> </tr> </table>	Marking	End Cover	0828736 UCT-TM 6	1088746 D-PTV 2,5/4	\$5.30 / Card	\$0.75		<p>\$1.60</p> <p>PTV 4-QUATTRO 1088734</p> <p>AWG 24 ... 10 — 600V / 30A</p> <p>Accessories</p> <table border="1"> <tr> <th>Marking</th> <th>End Cover</th> </tr> <tr> <td>0828736 UCT-TM 6</td> <td>1088748 D-PTV 2,5/4-QUATTRO</td> </tr> <tr> <td>\$5.30 / Card</td> <td>\$0.80</td> </tr> </table>	Marking	End Cover	0828736 UCT-TM 6	1088748 D-PTV 2,5/4-QUATTRO	\$5.30 / Card	\$0.80
Marking	End Cover																						
0828736 UCT-TM 6	1088746 D-PTV 2,5/4																						
\$5.30 / Card	\$0.75																						
Marking	End Cover																						
0828736 UCT-TM 6	1088746 D-PTV 2,5/4																						
\$5.30 / Card	\$0.75																						
Marking	End Cover																						
0828736 UCT-TM 6	1088748 D-PTV 2,5/4-QUATTRO																						
\$5.30 / Card	\$0.80																						

Tool deals you wouldn't want to miss!

TOOLfox

	<p>\$33.50</p> <p>CUTFOX 12 1212128</p> <p>Cable cutters, up to 12 mm diameter cables</p>		<p>\$55.25</p> <p>CUTFOX 18 1212129</p> <p>Cable cutters, up to 18 mm diameter cables</p> <ul style="list-style-type: none"> • Spring loaded with lock • Angled head • Ergonomic design 		
	<p>\$155.00</p> <p>CRIMPFOX CENTRUS 10S 1213154</p> <p>Crimping tool for ferrules from 24-8 AWG.</p> <p>Square crimp shape</p>		<p>\$155.00</p> <p>CRIMPFOX CENTRUS 10H 1213156</p> <p>Crimping tool for ferrules from 24-8 AWG.</p> <p>Hexagonal crimp shape</p>		 <p>\$72.25</p> <p>WIREFOX-D 40 1212161</p> <p>Stripping tool for conductors and cables.</p> <p>4.5-40 mm adjustable cutting depth</p>
	<p>\$37.00</p> <p>WIREFOX-D 11 1212160</p> <p>Stripping tool for power and data lines.</p> <p>Diameter: 2.5-11 mm</p>		<p>\$79.50</p> <p>WIREFOX-E 10 1212706</p> <p>Stripping tool, for cables and conductors from: 0.02 - 10 mm²</p>		 <p>\$37.00 ea.</p> <p>AI SORTI BOX RD 3202960</p> <p>AI-TWIN SORTI BOX BU 3202986</p> <p>Assortment box, supplied with ferrules according to DIN 46228-4: 1990-09, 50 pcs.</p>